

# Development of the College Campus

The Steering Committee responsible for the formation of the College district recognized that selection of a site for a future campus would be a very emotional issue, one that they referred to as a “sticky question.” “Sticky questions” would be handled with openness and wide publicity to allow for the greatest possible input into the decisions. However, according to state statute, the location of the campus could only be decided by the Board of Trustees. Therefore, the Steering Committee made the campus site selection a non-issue in the vote to establish the district.

Mr. Clem Phipps, chairman of the first Board of Trustees, said that “There is probably no decision of greater interest nor more universal importance than the selection of a college campus site, especially if there are several communities interested in the site.” The Board selected two architectural firms- - John Shaver and Company from Salinas, Kansas and Philips, Swager and Associates of Peoria- to assist in the process of selecting a site and developing a master plan for the campus.

A total of eleven (11) sites were proposed, three of which were in the Mattoon area. After careful evaluation, the site committee recommended a 308-acre site at the southern edge of the city limits of Mattoon near Interstate 57. Since all of the college's students would be commuting to campus, trustees felt this location near the interstate was the most desirable. Trustees unanimously approved the site and found it to be more than adequate for construction of the campus. It also provided acreage for nature preserves and demonstration farms.

The site is located geologically at the south edge of the Wisconsin glaciation and extends into the Shelbyville moraine at the north edge of the Illinois glaciation. There are a total of sixteen (16) soil types found on the College farm. The different soils make the site a good place of study for agriculture students.

In 1994 the College acquired an additional 3.65 acres of land from the Morgan family. The house was converted to an office for the Public Safety Department.

# Kluthe Center for Higher Education and Technology

The Lake Land College Kluthe Center for Higher Education and Technology, which began offering classes during the fall of 1995, is the College's first permanent extension center. Nearly 1,500 residents enroll in more than 80 different classes during the day, evening and weekend, making it the largest extension center in the college district and perhaps in the state.

The two-story, 24,000-square-foot structure was built with a \$250,000 grant from the estate of Minnie Kluthe, \$750,000 of locally donated funds and a \$1.48 million grant from the State of Illinois. The site was donated by a group of business men called "Technology Partners." The City of Effingham and Effingham County extended utilities and streets to the site at no cost to the College.



# Western Region Center



Located at 600 E. First St. in Pana, the Western Region Center first opened in January 2007. The center was a unique partnership between Casey's General Stores, First National Bank of Pana, and Pana Community Unit School District (CUSD) #8. Through this agreement, a former Casey's General Store was renovated as a Lake Land facility, offering two classrooms, a resource area and an administrative assistant's office. Three years after the 2,192-square-foot facility opened, Pana CUSD initiated a 6,000-square-foot addition which expanded higher education opportunities to Lake Land students in Pana and the surrounding area, including a licensed practical nursing program. Additional funding for the addition stemmed from a federal earmark. The center now serves about 100 students a year.

# Eastern Region Center at the Forsythe Center



Located at 224 South Sixth St. in Marshall, the Eastern Region Center at the Forsythe Center emerged from a partnership among city officials, Lake Land College, Jerry Forsythe and area businesses and families.

Marshall High School dual credit automotive students were the first to take classes in the facility beginning in the fall of 2007. General education and technical career courses were first offered January 2008. The 8,000-square-foot-facility houses an automotive garage, welding lab, four classrooms, including a computer lab and a community resource room. The center serves about 90 students per year.

# Workforce Development Center



The Lake Land College Workforce Development Center houses the college's Center for Business and Industry, Pathways to the Future alternative high school, Community and Professional Programs, Traffic Safety and Commercial Driver Training. The building also houses the Illinois Department of Employment Security. Located at 305 Richmond Ave., East, Mattoon, the center originally opened in 1999 as a one-stop Illinois Employment & Training Center. The center occupies 31,384 square-feet and includes a Manufacturing Skills Training Lab, several training rooms available for the public to rent and classrooms for computer training. In 2008 the college bought the entire 78,945 square-foot building and now leases the center store to the Dollar General Store and the far south side to a local church.

# The Campus through the Years

**1971**

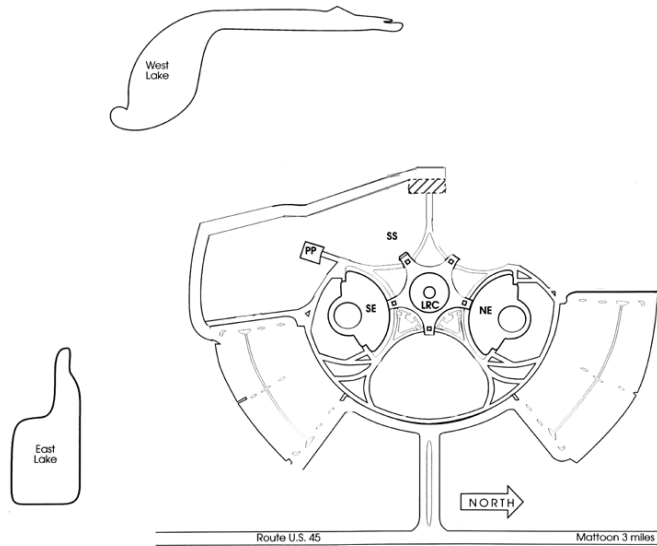

**1974**

**New Addition**

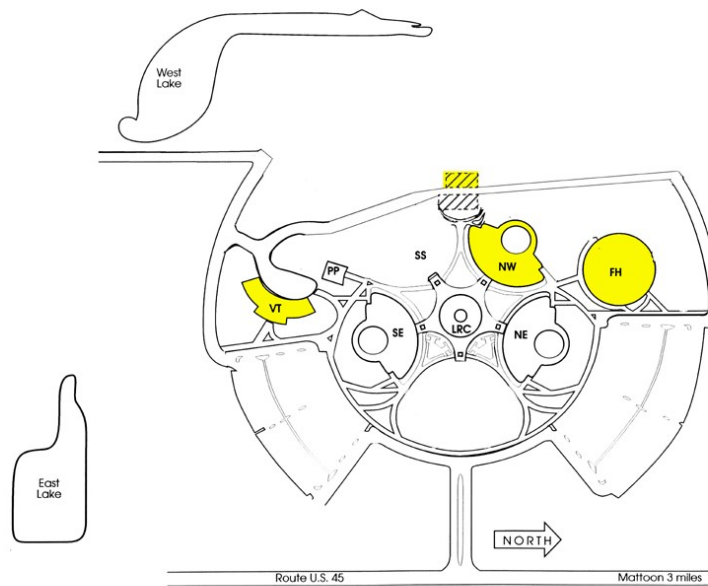

# The Campus through the Years

**1977**

 **New Additions**

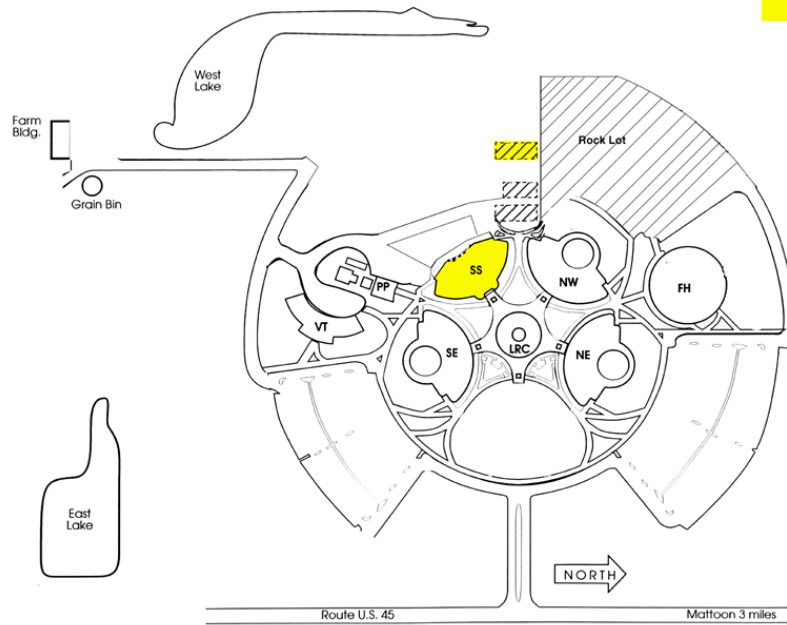

**1988**

 **New Addition**

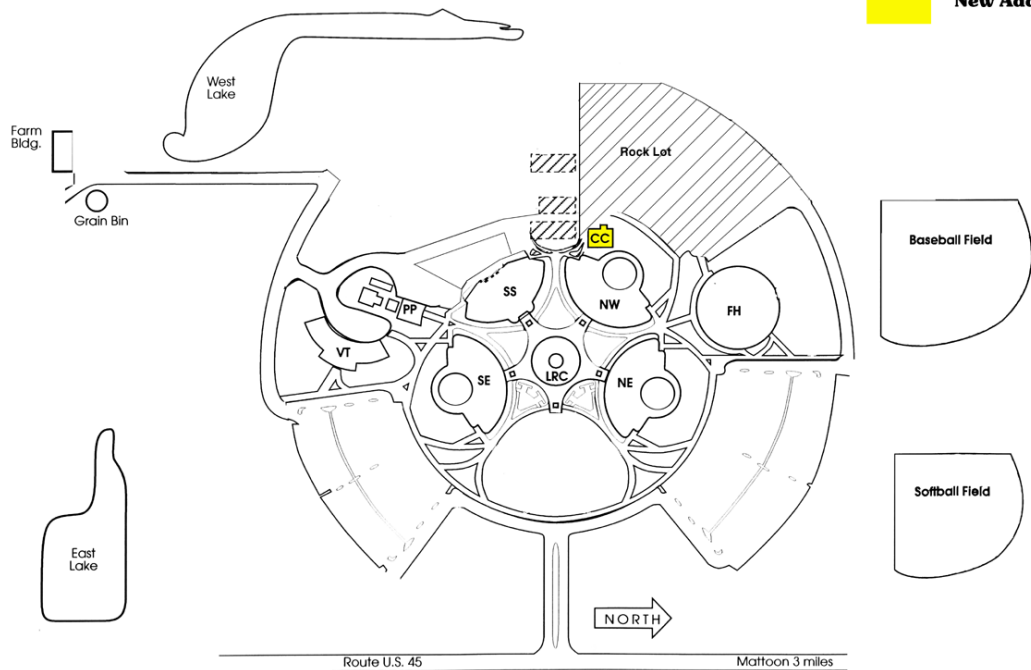

# The Campus through the Years

**1993**

 **New Addition**

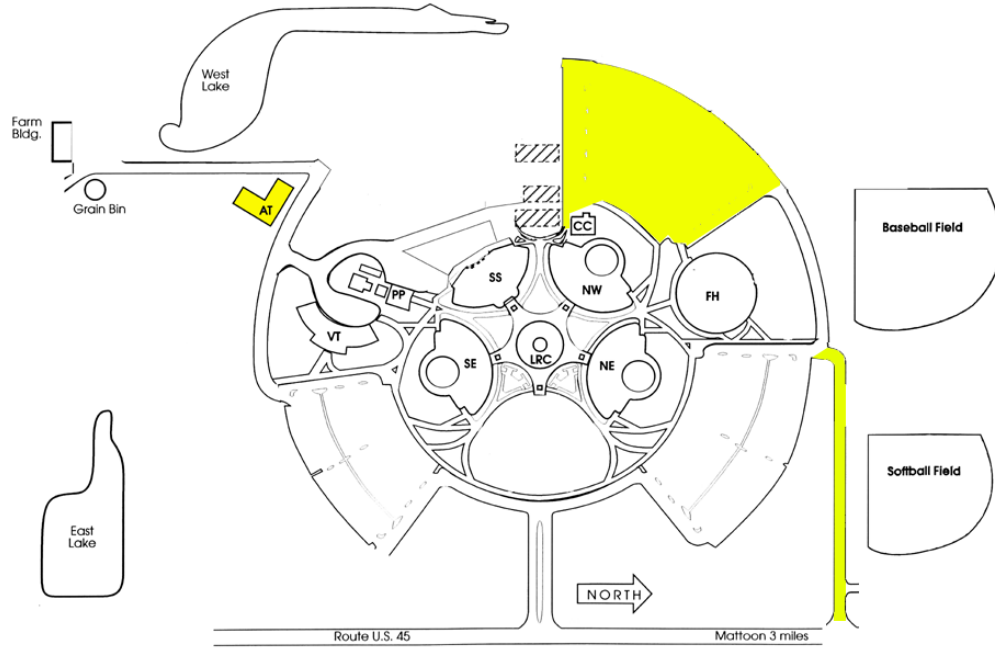

**1996**

 **New Additions**

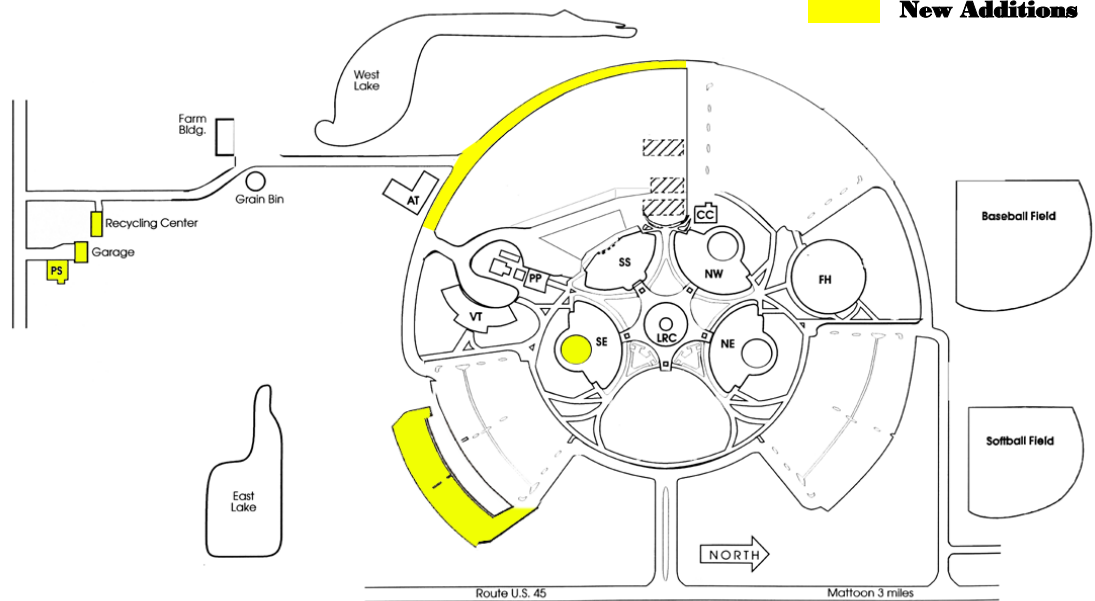



# The Campus through the Years

1999

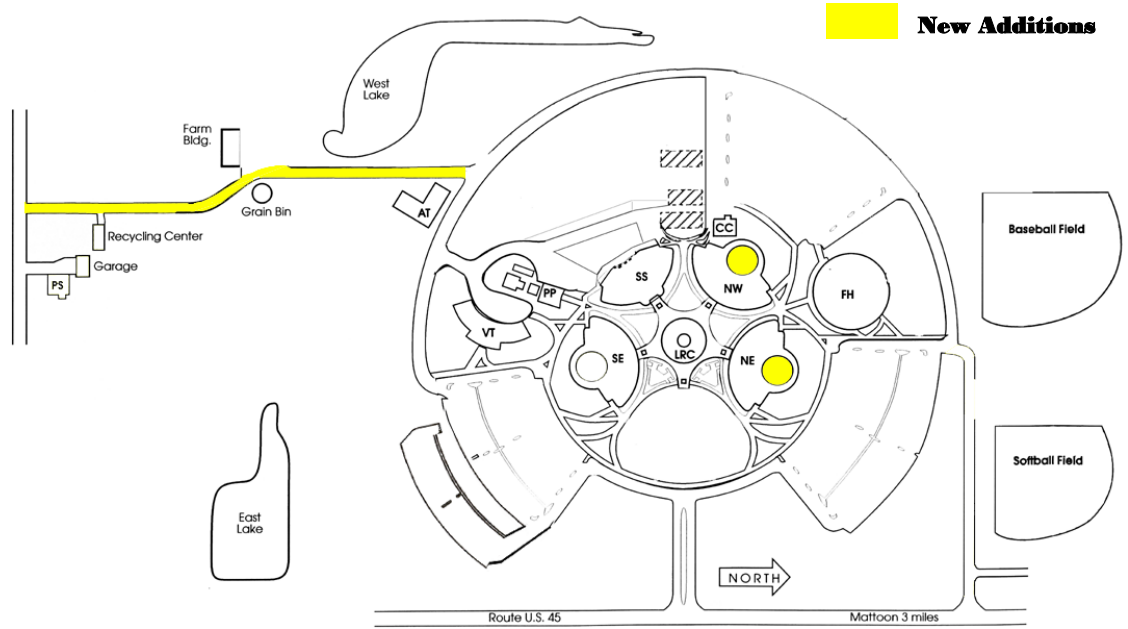

2000

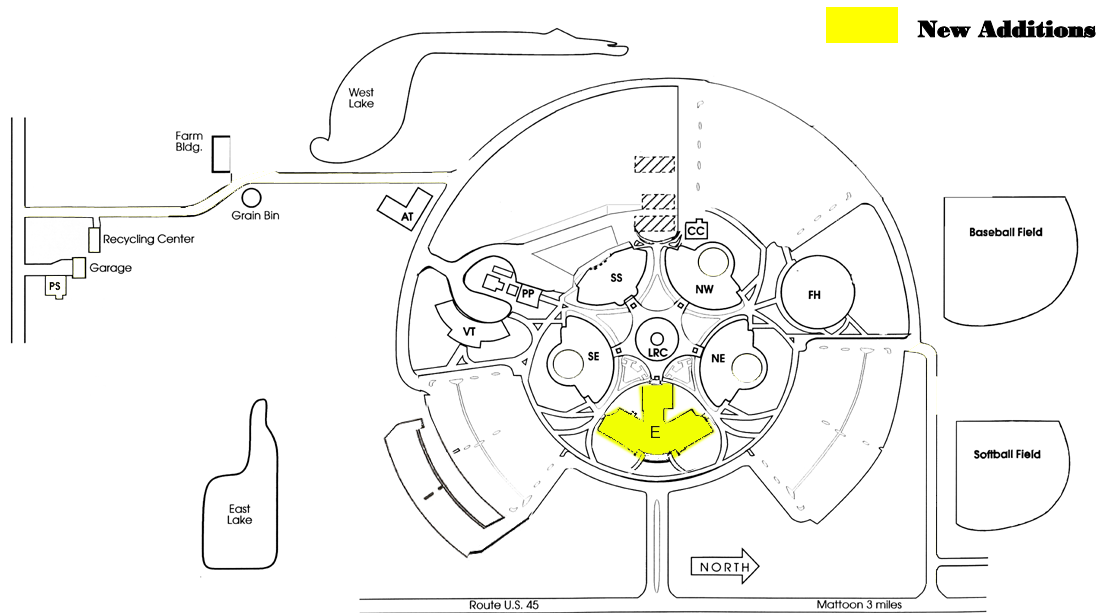

# The Campus through the Years

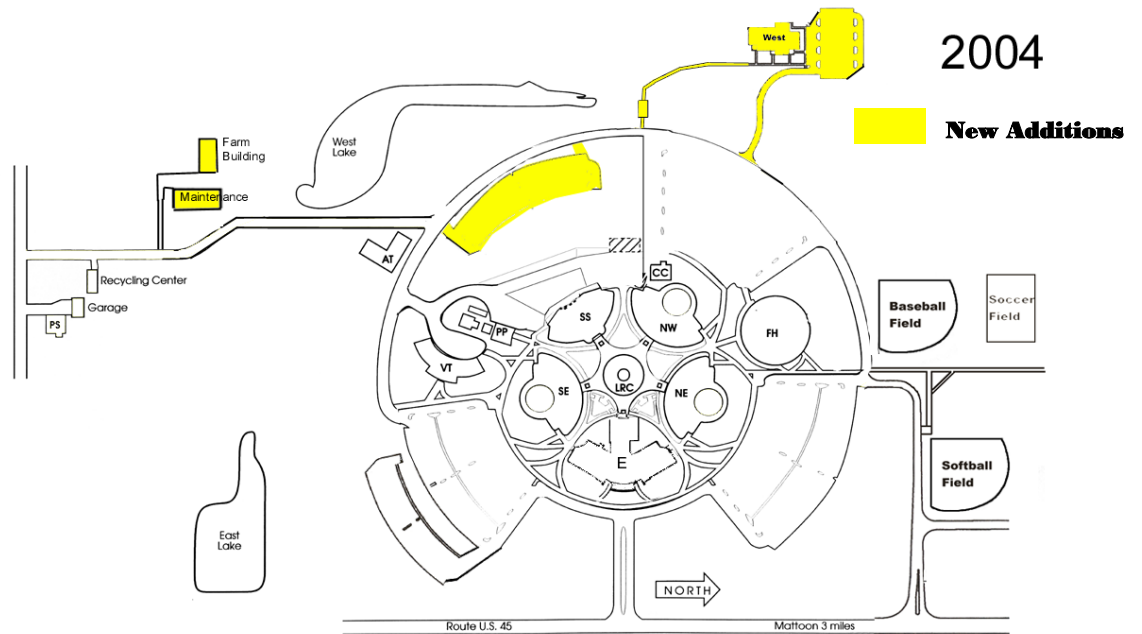
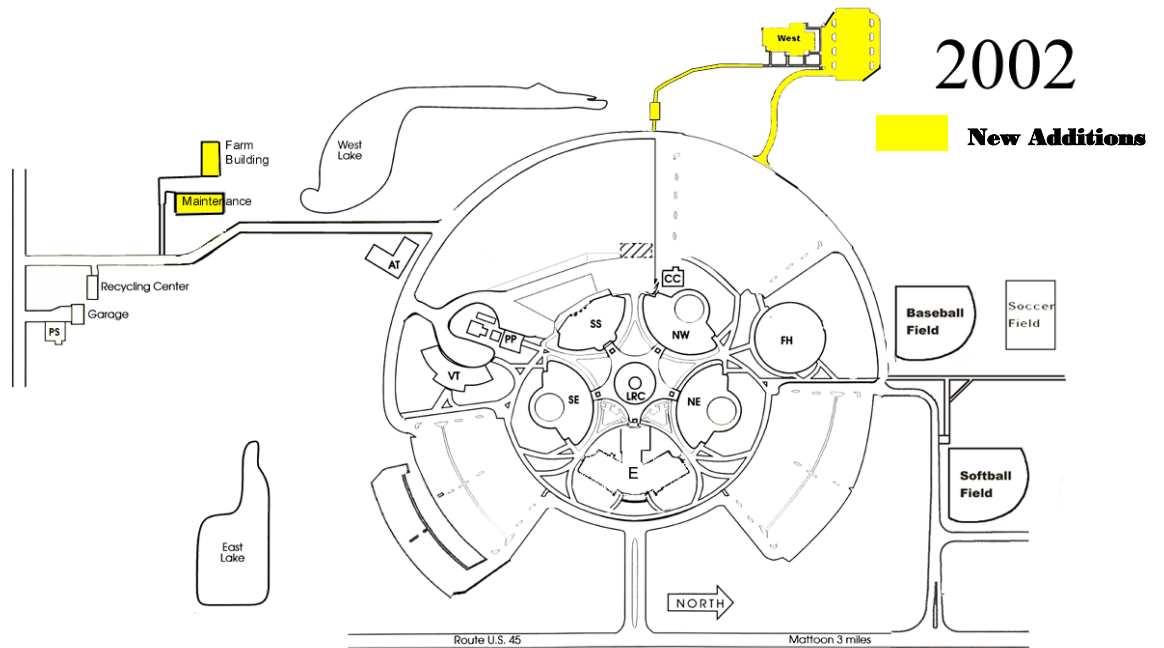

# The Campus through the Years

## Lake Land College 2010

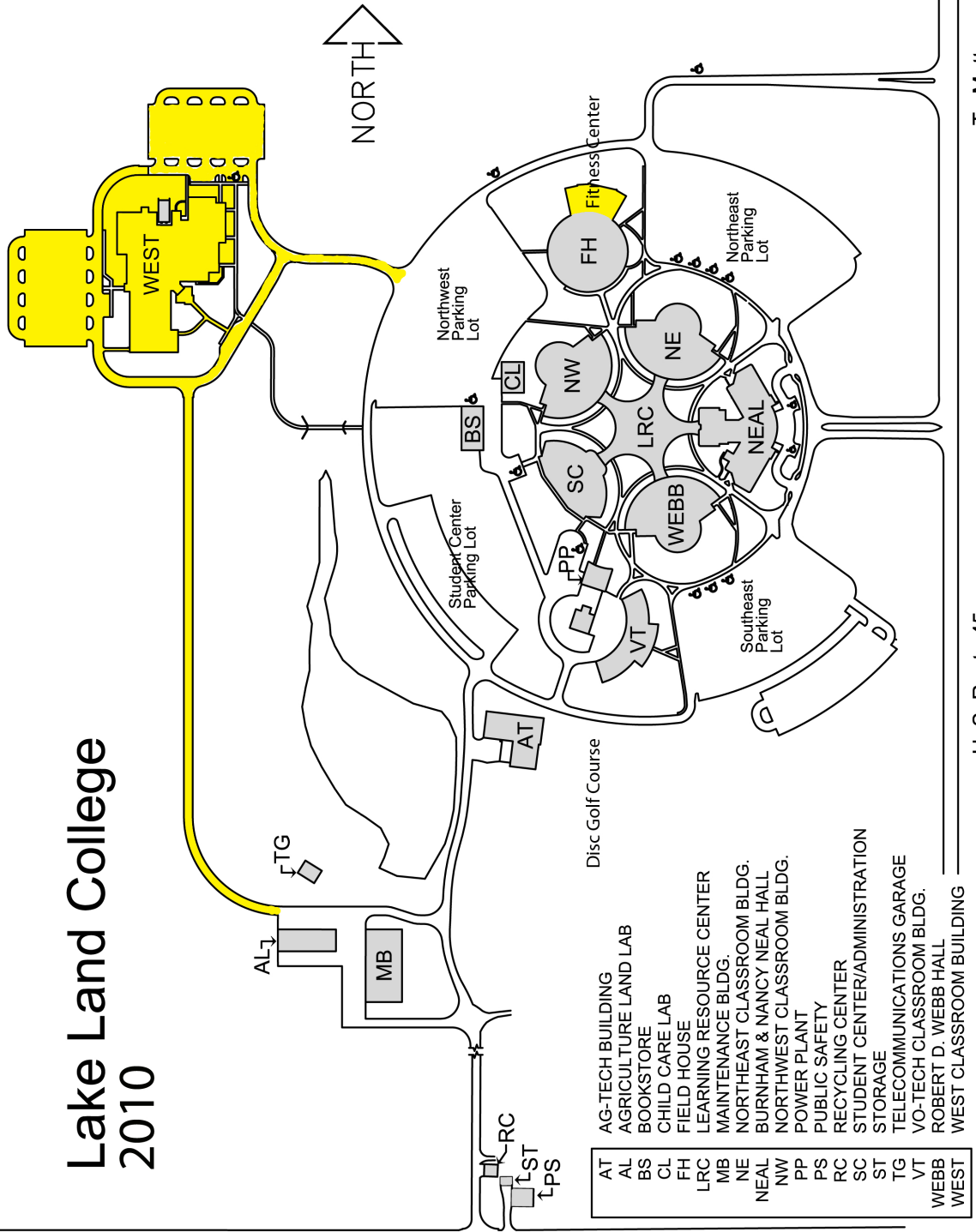







- |      |                               |
|------|-------------------------------|
| AT   | AG-TECH BUILDING              |
| AL   | AGRICULTURE LAND LAB          |
| BS   | BOOKSTORE                     |
| CL   | CHILD CARE LAB                |
| FH   | FIELD HOUSE                   |
| LRC  | LEARNING RESOURCE CENTER      |
| MB   | MAINTENANCE BLDG.             |
| NE   | NORTHEAST CLASSROOM BLDG.     |
| NEAL | BURNHAM & NANCY NEAL HALL     |
| NW   | NORTHWEST CLASSROOM BLDG.     |
| PP   | POWER PLANT                   |
| PS   | PUBLIC SAFETY                 |
| RC   | RECYCLING CENTER              |
| SC   | STUDENT CENTER/ADMINISTRATION |
| ST   | STORAGE                       |
| TG   | TELECOMMUNICATIONS GARAGE     |
| VT   | VO-TECH CLASSROOM BLDG.       |
| WEBB | ROBERT D. WEBB HALL           |
| WEST | WEST CLASSROOM BUILDING       |

To Mattoon →

U. S. Route 45

# The Master Plan

## Lake Land College Master Building Plan

-  Existing Buildings
-  Funding Released by Governor
-  Student Funded
-  Planned Buildings on ICCB List
-  Future Projects
-  Privately Funded
- \* Presently the Learning Resource Center

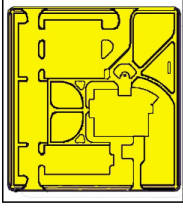

Western Region Tech Center,  
Pana

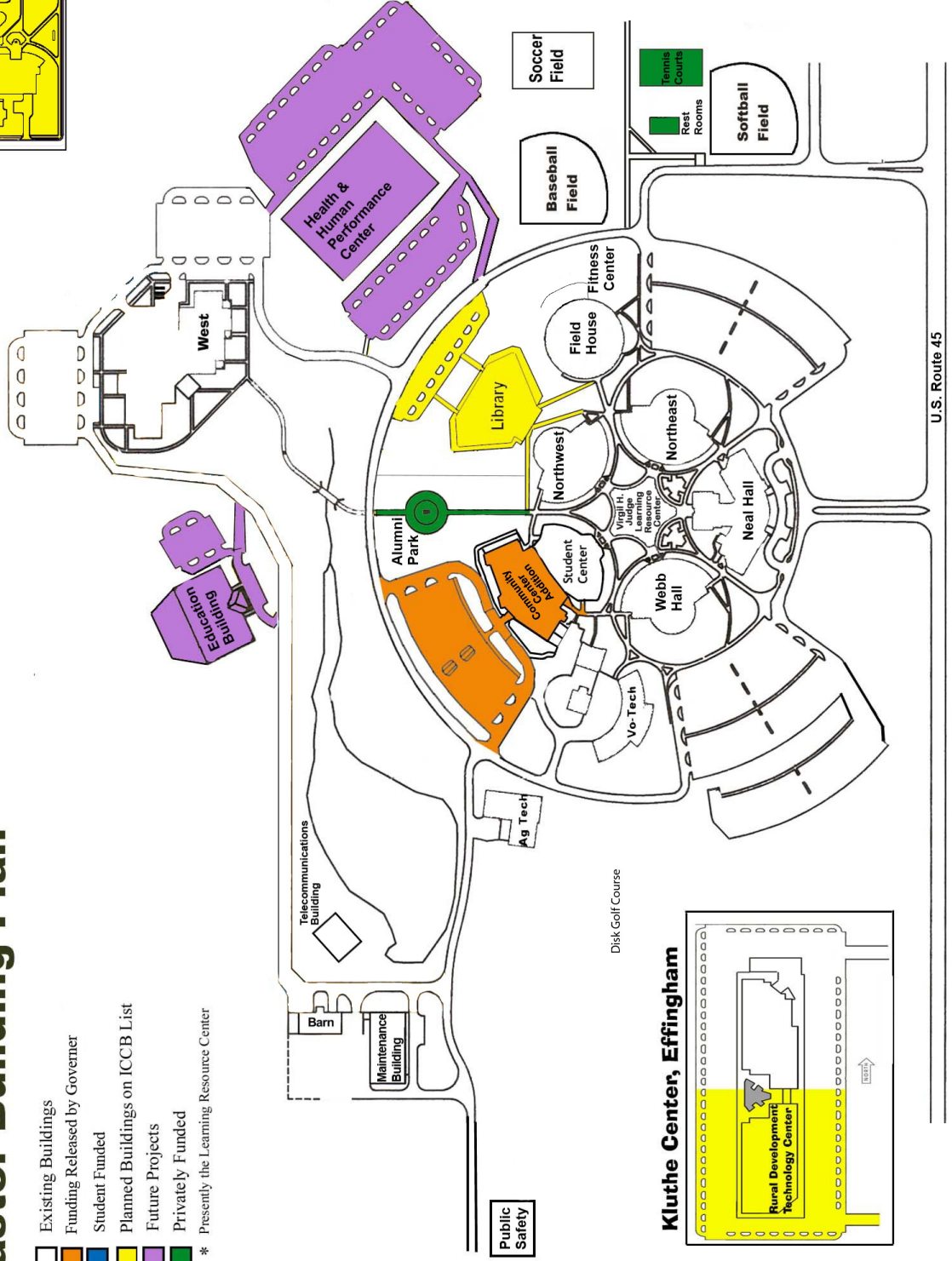

Kluthe Center, Effingham

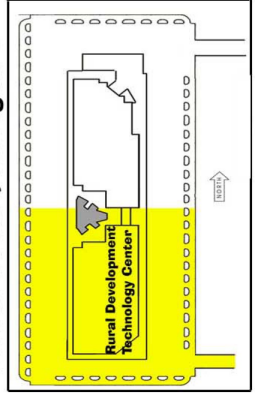

U.S. Route 45



# Facilities

Facility (T for temporary)	Date	Permanent GSF	Temporary GSF	Classrooms	Labs	Conf. Rooms	Offices	Student Study Area
<b>On Campus Totals 2020</b>		<b>444,353</b>	<b>30,492</b>	<b>56</b>	<b>87</b>	<b>17</b>	<b>263</b>	<b>47,989</b>
Virgil H. Judge LRC	1971	43,362		1	0	7	11	8,453
Northeast	1971	36,262		10	8	1	30	3,928
Webb Hall (Southeast)	1971	36,265		5	18	3	37	4,600
Power House	1971	4,771		0	0	0	0	0
Vo-Tech	1973	18,859		4	7	0	8	0
Field House	1974	54,799		5	0	1	13	0
Northwest	1974	36,043		11	12	1	29	4,542
Farm Building	2002	9,600		0	0	0	0	0
Luther Student Center (College Center)	1977/2020	35,000		0	1	3	72	2
Board and Administration Center*	1988/2018	5,371		0	0	2	6	0
<i>Ag Tech (T)</i>	1993		16,434	3	3	0	6	0
<i>Farm House (T)</i>	1994		3,219	0	0	1	3	0
<i>Farm House Garage(T)</i>	1994		682	0	0	0	0	0
Neal Hall (East Building)	2000	46,282		8	8	2	11	9,573
West Building	2002	84,012		9	29	3	29	16,891
Physical Plant (Maintenance/Central Receiving)	2002	29,671		0	0	0	7	0
Lensink Hall	2013	4,056		0	1	0	12	0
<i>Recycling Center (T)</i>	2014		2,577	0	0	0	0	0
<i>Storage Building (T)</i>	2003		2,580	0	0	0	0	0
<i>Storage Building #1 (T)</i>	2020		5,000	0	0	0	0	0
<b>Off Campus Totals 2020</b>		<b>72,646</b>	<b>0</b>	<b>21</b>	<b>17</b>	<b>3</b>	<b>35</b>	<b>1,304</b>
Kluth Center - Effingham	1995	24,366		10	8	1	11	312
Workforce Development Center	2008	31,384		4	4	2	18	0
Western Region Center - Pana	2007	8,891		3	4	0	3	992
Eastern Region Center - Marshall	2008	8,005		4	1	0	3	0
<b>Total On and Off Campus 2020</b>		<b>516,999</b>	<b>30,492</b>	<b>77</b>	<b>104</b>	<b>20</b>	<b>298</b>	<b>49,293</b>

\*Child Care Lab was renovated and converted to Board and Administration Center in 2018

\*Luther Student Addition was finished in 2020

# LAKE LAND COLLEGE

## Building Square Footage

<b>Permanent</b>			
<b><u>Existing Buildings</u></b>		<b><u>Leased Buildings</u></b>	
Learning Resource Center	43,362	Marshall Extension Center	8,005
Northeast	36,262	Pana Extension Center	8,891
Webb Hall	36,265	Workforce Development	31,384
Power House	4,771	<b>TOTAL</b>	<b>48,280</b>
Vocational/Technical	18,859		
Field House	54,799		
Northwest	36,043		
Luther Student Center	35,000		
Neal Hall	46,282		
West Building	84,012		
Physical Plant	29,671		
Farm Building	9,600		
Lensink Hall	4,056		
Board & Administration Center	5,371		
Kluthe Center (Effingham)	24,366		
<b>TOTAL</b>	<b>468,719</b>		
		<b><u>Total Square Footage</u></b>	
		<b><u>Buildings</u></b>	
		Existing Buildings	468,719
		Temporary Buildings	30,492
		Leased Buildings	48,280
		<b>TOTAL</b>	<b>547,491</b>
<b>Temporary</b>			
<b><u>Temporary Buildings</u></b>			
Ag Tech	16,434		
Farm House & Garage	3,901		
Recycling Center	2,577		
Storage Building 1	5,000		
Storage Building	2,580		
<b>TOTAL</b>	<b>30,492</b>		

Source: Director of Public Safety & Facility Planning

**Leased**